



Commercial Order Desk:

P 613 244 3773

F 613 244 8553

E order@eurotilestone.com

General Inquiries:

P 613 244 4315

F 613 244 4320

E info@eurotilestone.com

3103 Hawthorne Rd | Ottawa, Ontario K1G 3V8

Connect with us on:



<http://eurotilestone.com/>

Pro Acoustik Set™



Solvent-Free “Hi-Tack” Adhesive for PRO ACOUSTIK™ Rubber Underlayment

Pro Acoustik Set™ Adhesive is a homogeneous, ready-to-use, high-performance ‘Hi-Tack’ solvent free low-odor and freeze-thaw stable acrylic latex emulsion based adhesive specially formulated for installing PRO ACOUSTIK™ acoustic rubber underlayment.

Features

- ◆ For INTERIOR installation of PRO ACOUSTIK rubber underlayment over most dry, clean, properly prepared standard substrates.

Suitable Substrates

- ◆ Properly prepared clean, dry, fully cured concrete (at least 28 days old), free of moisture, rising moisture and alkaline conditions.
- ◆ Cementitious screeds, rendering, leveling coats and mortar beds.
- ◆ Exterior Glue Plywood and OSB panels that are recommended and/or guaranteed by the wood underlayment manufacturer.
- ◆ Properly prepared and leveled embossed vinyl flooring using a floor patching system for residential and light commercial duty floors only. (Please contact Proma’s representatives for complete details and recommendations)
- ◆ Contributes to LEED® objectives and requirements

Packaging

18.9L (5 U.S. gal) pail

Limitations

- ◆ Do not use for exterior installation.
- ◆ Do not use when the ambient and/or substrate temperatures are below 50°F (10°C) or above 95°F (35°C) and in ambient relative humidity conditions higher than 65%.
- ◆ Do not install Pro Acoustik rubber underlayment directly over damp concrete or over “On-Grade” and “Below-Grade” concrete slabs in high moisture or high water table areas.
- ◆ Do not use this adhesive over gypsum-based patching and leveling compounds.

Surface Preparation *(Refer to Proma Surface Preparation Guidelines for complete details)*

- ◆ Concrete substrates must be completely cured (at least 28 days old), dry and free of moisture or rising moisture conditions. **IMPORTANT: Perform moisture emission tests using a calcium chloride tester in accordance to ASTM F-1869. In all cases, the moisture vapor emission must not exceed 3lb per 1,000 ft² (1.36 kg per 93 m²) per 24 hours. If so, please use PRO PRIME MB primer-sealer to reduce moisture vapor emission by more than 50% (see technical data sheet for more information).**
- ◆ All supporting surfaces must be structurally sound, solid, stable, level, plumb and true.
- ◆ Surfaces must be clean and free of dust, oil, grease, paint, tar, wax, curing agent, primer, sealer or any deleterious substance and debris which may prevent or reduce adhesion.

- ◆ Acids, concentrated alkaline conditions and cleaning chemical residues must be neutralized or removed.
- ◆ Smooth concrete substrate surfaces must be mechanically roughened in accordance with an engineer-approved procedure (shot-blasting, scarification, grinding, sand or water-blasting, etc.) to remove all paint, loosely bonded toppings, loose particles and construction debris and to provide sufficient surface texture and profile for the adequate bonding of the subsequent leveling and/or setting material products.

Mixing

Ready-to-use. No mixing required. Just remove the container lid and spread the adhesive.

Application

- ◆ Do not spread more adhesive than can be covered with PRO ACOUSTIK rubber underlayment within 30 minutes.
- ◆ Set the PRO ACOUSTIK rubber underlayment while the adhesive is fresh. Do not allow the adhesive to skin-over or become dry before applying the rubber.
- ◆ Periodically lift the rubber underlayment material and check backs to ensure that there is sufficient and proper adhesive contact.
- ◆ Using the appropriate floor roller (75-100 lb weight), roll back and forth and across to remove all voids and blisters.
- ◆ Proceed with cutting and seaming in accordance with rubber manufacturer’s instructions.

Cleanup

- ◆ As the PRO ACOUSTIK rubber underlayment is being installed, immediately wipe off wet adhesive smudges and excess adhesive from the surface with a cloth dampened with water while the adhesive is wet or with mineral spirit if the adhesive has dried.
- ◆ Do not allow adhesive to harden on the rubber surface as cured adhesive is more difficult to remove.
- ◆ Promptly clean tools and hands with water while the adhesive is fresh.

Expansion and Control Joints

- ◆ Install control joints where rubber tiles abut restraining surfaces, around the perimeter of the work and at the base of columns and curbs.
- ◆ Install a suitable industry-approved compressible bead and flexible sealant to caulk expansion and control joints. Follow the sealant manufacturer’s installation instructions.

Protection

Note: Generally, at room temperature and 50% RH conditions, this adhesive will dry in about 24 hours.

- ◆ Avoid unnecessary walking on the floor during the installation.
- ◆ Protect floors from traffic for at least 24 hours.



Pro Acoustic Set™ (continued)

LIGHT CONCRETE SLAB

1. 3/4" Engineered or solid wood
2. Pro 9000™ wood flooring adhesive
3. Pro Acoustik™
4. Pro Acoustik Set™ adhesive
5. Light concrete floor slab 1 1/2"
6. 1/4" Insulation board
7. 3/4 or 5/8" plywood
8. Wood Joist or beam
9. Acoustic wool 6"
10. Z bar
11. 2 layers of Gypsum board

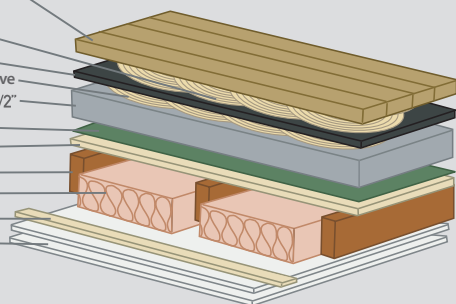

LIGHT CONCRETE SLAB

1. Finished floor (Tested with ceramic; also suitable for marble, granite and natural stones)
2. Pro Bond Plus System™ Premium Tile Installation System
3. Pro Acoustik™
4. Pro Acoustik Set™ adhesive
5. Light concrete floor slab 1 1/2"
6. 1/4" Insulation board
7. 3/4 or 5/8" plywood
8. Wood Joist or beam
9. Acoustic wool 6"
10. Z bar
11. 2 layers of Gypsum board

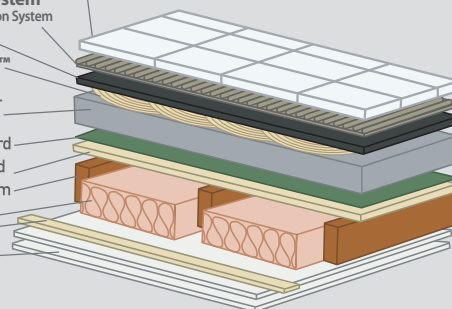

WOOD FRAME

1. 3/4" Engineered or solid wood
2. Pro 9000™ wood flooring adhesive
3. Pro Acoustik™
4. Pro Acoustik Set™ adhesive
5. 3/4 or 5/8" plywood
6. Wood Joist or beam
7. Acoustic wool 6"
8. Z bar
9. 2 layers of Gypsum board

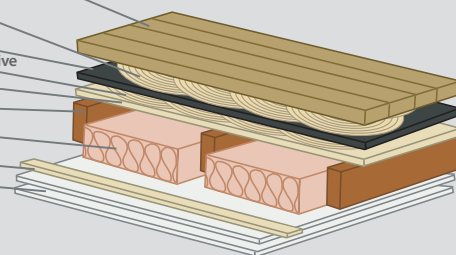

WOOD FRAME

1. Finished floor (Tested with ceramic; also suitable for marble, granite and natural stones)
2. Pro Bond Plus System™ Premium Tile Installation System
3. Pro Acoustik™
4. Pro Acoustik Set™ adhesive
5. 3/4 or 5/8" plywood
6. Wood Joist or beam
7. Acoustic wool 6"
8. Z bar
9. 2 layers of Gypsum board

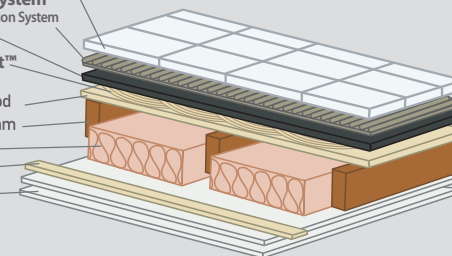

6" or 8" CONCRETE SLAB

1. Finished floor (1/2" wooden laths)
2. Pro 9000™ wood flooring adhesive
3. Pro Acoustik™
4. Pro Acoustik Set™ adhesive
5. 6" or 8" concrete slab

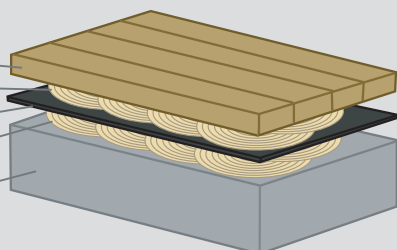

Warranty

Prima warrants that this product is manufactured using quality raw materials and is of merchantable quality and suitable for the purpose for which it was intended. Prima's liability under this warranty shall be limited to the replacement of its product proven to be defective. Neither seller nor manufacturer shall be liable for any injury, loss or damage, direct or consequential, arising from the use of/or the inability to use this product.

Contact Information

PROMA Adhesives Inc.

8500 Ernest-Cormier, Anjou, Quebec Canada H1J 1B4
 Tel.: 514.852.8585
 Fax: 514.852.8225
 Toll-free: 1 866.51.PROMA (77662)
 Email: info@proma.ca

Technical Data for PRO ACOUSTIK SET (@ 23°C [73°F] and 50% RH)

Wet open time:	Approx. 30 minutes
Base:	Synthetic latex
Weight/U.S. gal.:	12 lbs. approx.
Consistency:	Mastic
Flash point:	Nonflammable
Freeze/thaw stability:	To -12°C (+10°F)
Bonding to support (kg/cm):	3.4
Coating VOC:	0 calculated VOC
Appearance:	Beige mastic
Approximate coverage per 18.9 L (5 U.S. gal) pail	
Notched trowel	Coverage
5 mm (3/16") v-notch trowel	37 m ² (400 ft ²)
3 mm (1/8") v-notch trowel	46-55 m ² (500-600 ft ²)

Shelf life

12 months if kept in its original unopened packaging and stored in a dry location.
 PROTECT FROM FREEZING.

Health and Safety

Refer to the Material Safety Data Sheet (MSDS) for complete details.

09 31 00 THIN-SET TILING
 SETTING MATERIALS / SPECIALTY
Pro Acoustic Set